

welcome to DUKE GARDENS

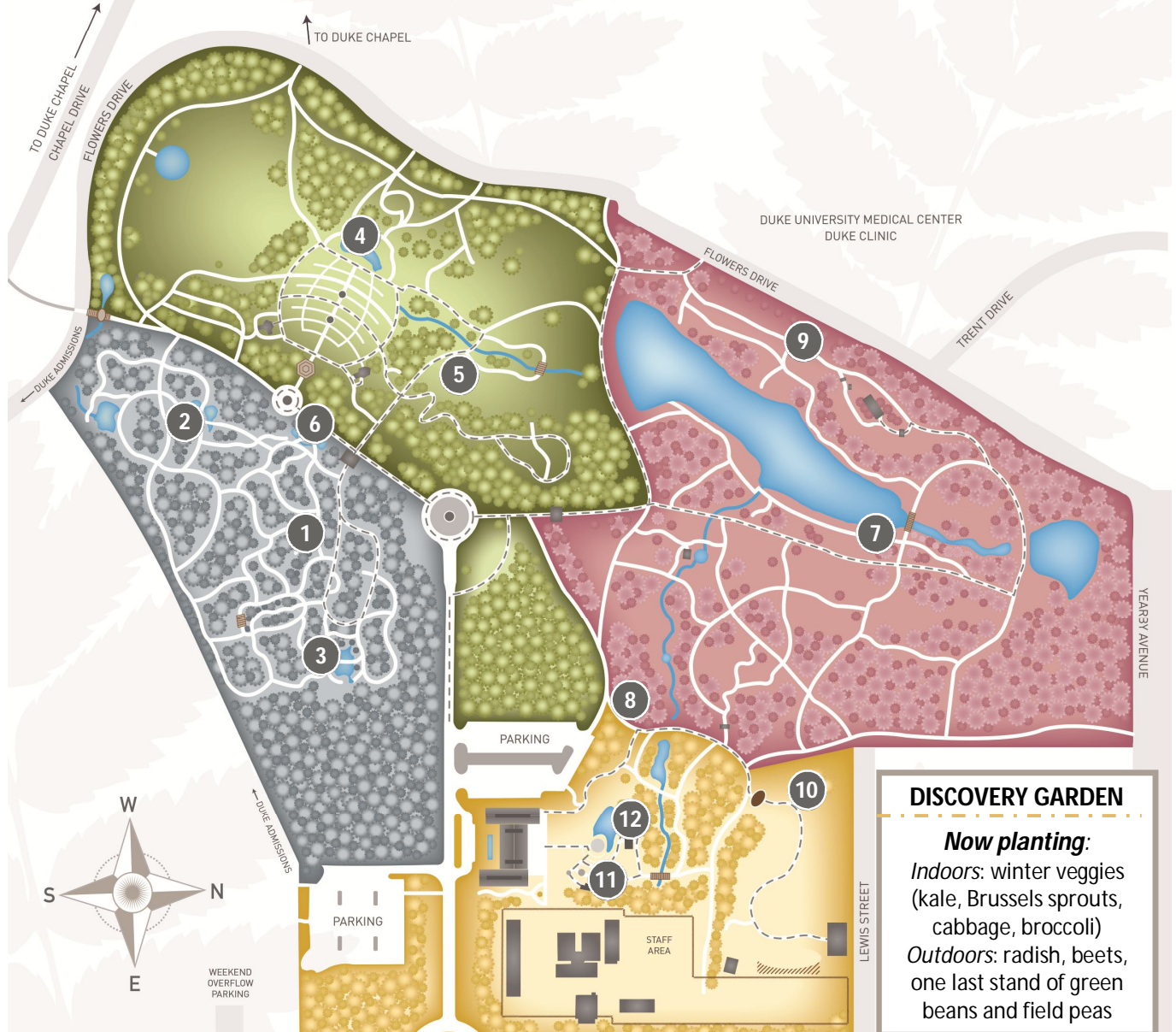

WHAT'S IN BLOOM

September 2, 2014



DISCOVERY GARDEN

Now planting:

Indoors: winter veggies (kale, Brussels sprouts, cabbage, broccoli)

Outdoors: radish, beets, one last stand of green beans and field peas

1 *Rudbeckia laciniata*
Cutleaf coneflower

2 *Vernonia noveboracensis*
New York Ironweed

3 *Physostegia virginiana*
Obedient plant

4 *Nymphaea* sp.
Waterlily

5 *Koelreuteria bipinnata*
Chinese flame tree

6 *Tricyrtis* sp.
Toad-lily

7 *Hedychium coronarium*
White ginger-lily

8 *Lespedeza thunbergii*
Thunberg's lespedeza

9 *Musa velutina*
Pink banana

10 *Hibiscus* sp.
Hardy hibiscus

11 Page-Rollins White Garden

12 *Nymphaea* sp.
Water lily

WHAT'S IN BLOOM

September 2, 2014



BLOMQUIST GARDEN OF NATIVE PLANTS

Callicarpa americana Beautyberry
Collinsonia canadensis Richweed
Collinsonia serotina Blue Ridge horsebalm
Eurybia divaricata White wood aster
Helianthus resinosus Resindot sunflower
Hibiscus dasycalyx Neches River rosemallow
Impatiens capensis Jewelweed
Physostegia virginiana Obedient plant

DORIS DUKE CENTER GARDENS

Abelia x grandiflora Glossy abelia
Canna sp. Canna Lily
Dicliptera suberecta Uruguayan firecracker plant
Echinacea sp. Coneflower
Eutrochium purpureum Joe Pye weed
Hedychium coronarium White ginger lily
Hibiscus sp. Hardy hibiscus
Hydrangea arborescens Smooth Hydrangea

CULBERSON ASIATIC ARBORETUM

Buddleja lindleyana Lindley's butterfly bush
Caryopteris 'Blue Butterflies' Bluebeard
Caryopteris incana Bluebeard
Cautleya spicata Chinese butterfly ginger
Hedychium coccineum Scarlet ginger-lily
Hedychium coronarium White ginger lily
Hedychium densiflora Ginger-lily

HISTORIC GARDENS

Abelia chinensis Chinese abelia
Asclepias tuberosa Butterfly milkweed
Calliandra haematocephala Powderpuff
Canna sp. Canna
Echinacea sp. Hybrid Coneflower
Eucomis comosa Pineapple lily
Eurybia divaricata White wood aster
Hydrangea paniculata Panicle hydrangea
Hydrangea quercifolia Oakleaf Hydrangea
Hylotelephium 'Herbstfreude' Autumn Joy sedum
Indigofera amblyantha Indigofera
Koelreuteria bipinnata Chinese flame tree
Lespedeza thunbergii Thunberg's lespedeza

Rhexia mariana Maryland meadowbeauty
Rudbeckia laciniata Cutleaf coneflower
Rudbeckia fulgida Orange coneflower
Silphium asteriscus Starry rosinweed
Smallanthus uvedalius Hairy leafcup
Solidago plumosa Plumed goldenrod
Vernonia noveboracensis New York ironweed

Hydrangea quercifolia Oakleaf hydrangea
Lespedeza thunbergii Thunberg's lespedeza
Nelumbo nucifera Lotus
Nymphaea sp. Waterlily
Phlox paniculata Garden phlox

Hemerocallis sp. Daylily
Hosta sp. Hosta
Lespedeza thunbergii Lespedeza
Musa velutina Pink banana
Patrinia scabiosifolia Golden lace

Nelumbo nucifera Lotus
Nymphaea sp. Waterlily
Rosa sp. Rose
Rudbeckia fulgida Orange coneflower
Serissa foetida Pink snow rose
Tibouchina grandiflora Princess-flower
Tricyrtis sp. Toad lily

welcome to DUKE GARDENS



WHAT'S IN BLOOM

September 29, 2014

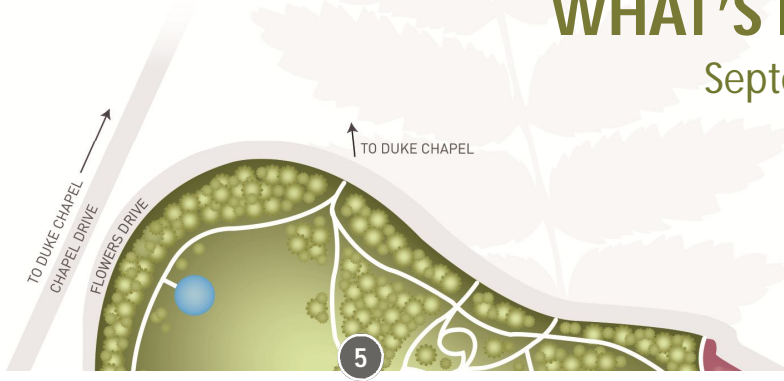

DUKE UNIVERSITY MEDICAL CENTER

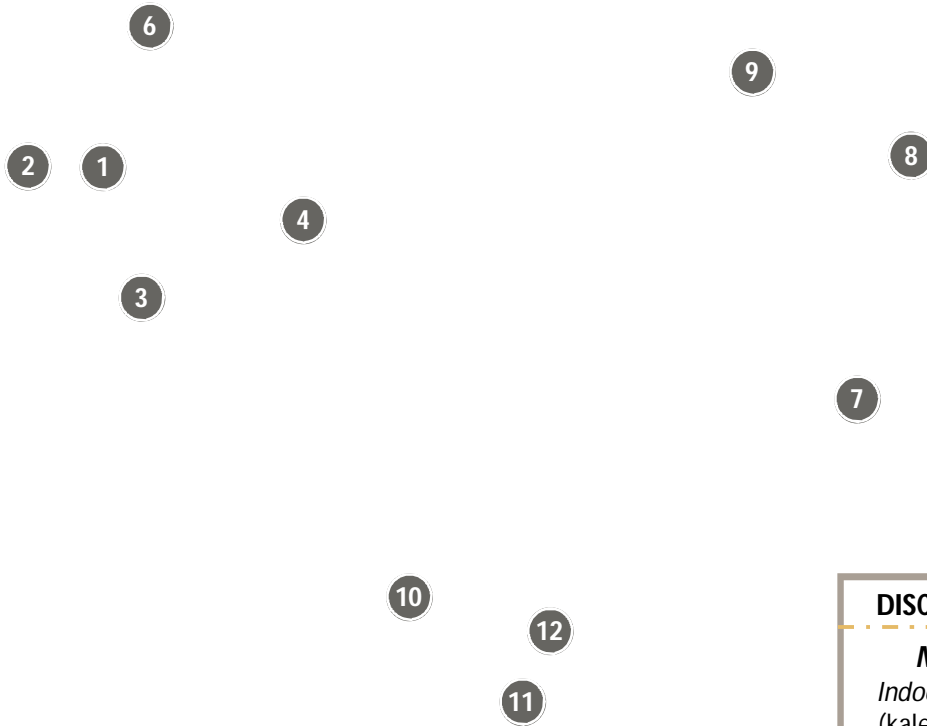

DISCOVERY GARDEN

Now planting:

Indoors: winter veggies
(kale, Brussels sprouts,
cabbage, broccoli)

Outdoors: radish, beets,
one last stand of green
beans and field peas

1 *Eurybia divaricata*
White wood aster

2 *Solidago plumosa*
Plumed goldenrod

3 *Callicarpa americana*
Beautyberry

4 *Camellia* 'Maiden's Blush'
Sasanqua camellia

5 *Rhododendron* sp.
Azalea

6 *Spiranthes odorata*
Fragrant lady's tresses

7 *Aster tataricus*
Tatarian aster

8 Japanese Garden progress
Viewing area to see completed
construction of stream

9 *Musa velutina*
Pink banana

10 *Muhlenbergia capillaris*
Pink muhly grass

11 *Salvia leucantha*
Mexican bush sage

12 *Nymphaea* sp.
Water lily

WHAT'S IN BLOOM

September 29, 2014



BLOMQUIST GARDEN OF NATIVE PLANTS

Callicarpa americana Beautyberry
Euonymus americanus Bursting-heart
Eurybia divaricata White wood aster
Helianthus resinosus Resindot sunflower
Heliopsis helianthoides Smooth oxeye
Hibiscus dasycalyx Neches River rosemallow
Impatiens capensis Jewelweed
Rudbeckia laciniata Cutleaf coneflower

DORIS DUKE CENTER GARDENS

Abelia x grandiflora Glossy abelia
Anemone x hybrida Windflower
Eurybia divaricata White wood aster
Gaura lindheimeri Gaura
Hedychium coronarium White ginger lily
Nymphaea sp. Waterlily
Muhlenbergia capillaris Pink muhly grass

CULBERSON ASIATIC ARBORETUM

Anemone sp. Windflower
Aster tataricus Tatarian aster
Callicarpa cathayana Beautyberry
Camellia sinensis Tea camellia
Chrysanthemum sp. Decorative mum
Gymnaster savatieri Gymnaster
Hedychium coccineum Scarlet ginger-lily
Hedychium coronarium White ginger lily
Hedychium densiflora Ginger-lily

HISTORIC GARDENS

Abelia chinensis Chinese abelia
Anemone x hybrida Windflower
Aster tataricus Tatarian aster
Camellia sasanqua Sasanqua camellia
Camellia sinensis Tea camellia
Eucomis comosa Pineapple lily
Eurybia divaricata White wood aster
Koelreuteria bipinnata Chinese flame tree
Nymphaea sp. Waterlily
Osmanthus fragrans var. aurantiacus Orange tea-olive
Rosa sp. Rose
Salvia koyamae Yellow sage
Spiranthes odorata Fragrant lady's tresses

Scutellaria montana Large-flowered skullcap
Solidago plumosa Plumed goldenrod
Verbesina occidentalis Yellow crownbeard
Vernonia noveboracensis New York ironweed

Phlox paniculata Garden phlox
Rosa sp. Hybrid rose
Salvia leucantha Mexican bush sage

Hosta sp. Hosta
Hydrangea macrophylla Bigleaf hydrangea
Leucosceptrum japonicum Japanese shrub mint
Musa velutina Pink banana
Osmanthus fragrans var. aurantiacus Orange tea-olive
Salvia glabrescens Woodland sage
Tricyrtis lasiocarpa Toad lily

Tibouchina grandiflora Princess-flower
Tinantia pringlei Mexican speckled tinantia
Tricyrtis sp. Toad lily
Viburnum setigerum Tea viburnum